

## Self Indicating Dynamometer

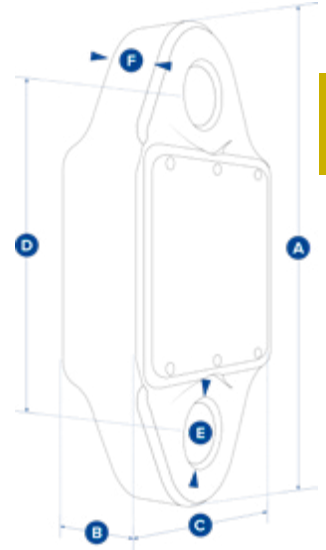

- Large 1 in LCD display
- 0.2% high accuracy
- Overload counter
- 90db Audible set point alarm
- RS-485 serial output
- IP65 / NEMA 4X
- Design validated by F.E.A.
- 2-year warranty
- Design Factor: 6:1
- Battery Type: 9v PP3
- Battery Life: 80 hrs continuous
- Operating Temp: 4 to 122° F.
- Accuracy: +/- 0.2% of full scale.
- Display Type: 6 digit 1 in LCD.
- Protection: IP65 / NEMA 4X.



## Straightpoint Self Indicating Dynamometer (SID)

Stock No.	Model	Capacity (lb)	Resolution (lb)	Weight (lb)	Dimensions (in)						Crosby Shackle	
					A	B	C	D	ØE	F		
2789709	SID6T5	14,300	2	3.3	8.82	1.73	4.45	6.14	1.08	1.3	G2130	1019533

Designed to replace outdated mechanical products still in the field, the Self Indicating Dynamometer (SID) is the latest Crosby Straightpoint product with a self-indicating display that provides accurate load measurements to prevent incidents and injuries.

The SID is a self-indicating version of the popular BlueLink and provides load monitoring solutions where close-up measurements are required, such as when operating lever and chain hoists at height or lifting vehicle motors.

The SID's advanced microprocessor-based electronics deliver high-speed read rates, extreme resistance to industrial-level noise, and unprecedented stability. It features full-function push button controls for:

- Tare and preset tare
- Selectable measurement units (lbs, kg, kN and tonnes)
- 100Hz high-speed peak hold
- Audible set-point alarm
- Overload counter

Designed for use with industry-standard Crosby G-2130 shackles, the SID's compact design minimizes headroom loss (6.14 in from eye to eye).

Constructed with high-grade aircraft-quality aluminum and with a 6:1 Design Factor, its lightweight design does not sacrifice on strength. In fact, Crosby SP link style dynamometers are, on average, 30% lighter than those of other suppliers.