

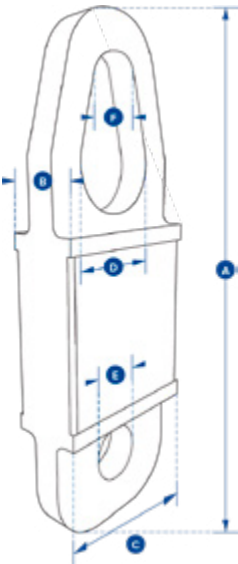

Towcell®



- Unique design fits any standard 2 inch tow hitch.
- Waterproof IP67 or NEMA6.
- Internal antenna.
- Compact size and lightweight.
- Proprietary 2.4 GHz wireless communication.
- Design validated by FEA.
- Bluetooth enabled and is supplied with a free HHP app for iOS and Android.
- Battery type: 4 x AA standard alkaline providing up to 500 hours battery life.
- Design factor: 5:1.
- Accuracy: 2% of Full Scale.
- Range (max): 100 m.
- Operating Temperature: -10°C to +50°C.
- Data Rate: 50 Hz



Straightpoint Towcell®

Stock No.	Model	Capacity (kN)	Resolution (kN)	Weight (kg)	Dimensions (mm)					
					A	B	C	ØD	ØE	ØF
2789271	Towcell - Bluetooth	25	0.01	1.4	300	43	104	51	27	31

Only sold in Europe. Does not meet US towing requirements.

The Crosby Straightpoint Towcell® is a 25kN wireless loadcell, specifically engineered for the emergency services, salvage, and 4x4 industries.

The Towcell allows for increased safety and the avoidance of costly overloads by providing real-time monitoring of tensile towing forces during recovery, clearance and salvage efforts.

The Towcell is rugged, lightweight, compact, and can be installed, with ease, onto any tow bar, whether it's a standard 52mm or 2 in ball or pin assembly and is ready to use in seconds.

Modeled after the Crosby SP bestselling Radiolink Plus, the Towcell is constructed of high-quality aircraft grade aluminum. It features an advanced internal design structure, providing the product with an unrivaled strength to weight ratio. This optimal balance allows for the use of a separate internally sealed enclosure. This administers the internal electronic components with an IP67 or NEMA6 waterproof environmental protection, even with the battery cover plate missing.

Towcell utilizes an unbreakable internal antenna and boasts an unmatched battery life.