

**A-1338**

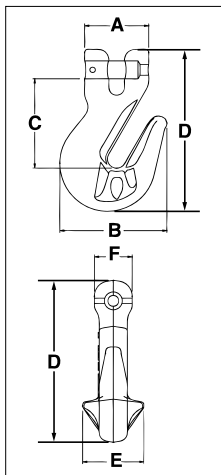

- Forged alloy steel — Quenched & Tempered.
- Innovative cradle design allows for 100% efficiency of Grade 100 chain.
- Individually Proof Tested to 2-1/2 times the Working Load Limit with certification.
- Each hook has a Product Identification Code (PIC) for material traceability, along with the size and the name Crosby.
- Suitable for use with Grade 100 and Grade 80 chain.
- The use of A-1338 Cradle Grab Hook will allow 100 percent of the chain sling capacity. When used to hook back to chain leg to form a choker, the angle of the choke must be 120 degrees or greater. When used as a chain shortener, minimize twist of chain and ensure chain is fully engaged in hook.
- Fatigue rated to 20,000 cycles at 1-1/2 times the Working Load Limit.

**L-1338**



**A/L-1338 Cradle Grab Hook**

Chain Size (in) (mm)	Working Load Limit (t)	A-1338 Stock No.	L-1338 Stock No.	Weight Each (kg)	Dimensions (mm)						S-4338 Replacement Latch Kit Stock No.
					A	B	C	D	E	F	
1/4 7	2.0	1049417	1049480	.20	43.7	64.5	55.9	98.5	38.1	22.4	1048426
5/16 8	2.6	1049426	1049489	.45	43.7	64.5	55.4	98.5	38.1	22.4	1048426
3/8 10	4.0	1049435	1049498	.82	47.0	78.5	65.5	119	46.5	27.7	1048435
1/2 13	6.8	1049444	1049507	1.78	60.7	97.3	83.3	149	57.2	36.1	1048444
5/8 16	10.3	1049453	1049516	3.18	67.8	115	97.8	179	74.5	44.5	1048453

4:1 Design Factor.

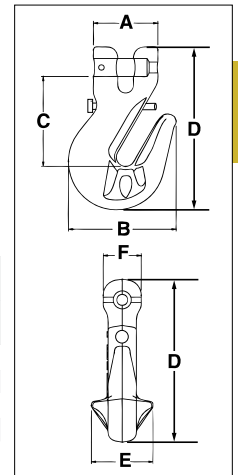

**6**

**A-1358**



- Forged alloy steel — Quenched & Tempered.
- Individually Proof Tested to 2-1/2 times the Working Load Limit with certification.
- Each hook has a Product Identification Code (PIC) for material traceability, along with the size and the name Crosby.
- Suitable for use with Grade 100 and Grade 80 chain.
- Fatigue rated to 20,000 cycles at 1-1/2 times the Working Load Limit.

APPLICATION AND WARNING INFORMATION SECTION 17

**L-1358**

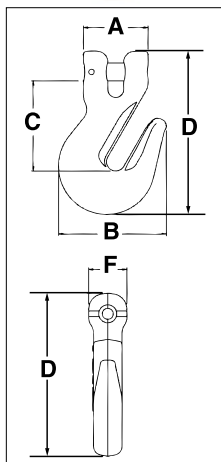

**A/L-1358 Grab Hook**

Chain Size (in) (mm)	Working Load Limit (t)	A-1358 Stock No.	L-1358 Stock No.	Weight Each (kg)	Dimensions (mm)					S-4338 Replacement Latch Kit Stock No.
					A	B	C	D	F	
1/4 7	2.0	1049610	1049605	.20	43.7	64.5	55.9	98.5	22.4	1048426
5/16 8	2.6	1049629	1049614	.45	43.7	64.5	55.4	98.5	22.4	1048426
3/8 10	4.0	1049638	1049623	.82	47.0	78.5	65.5	119	27.7	1048435
1/2 13	6.8	1049647	1049634	1.78	60.7	97.3	83.3	149	36.1	1048444
5/8 16	10.3	1049656	1049643	3.18	67.8	115	97.8	179	44.5	1048453

4:1 Design Factor.

