

**G-209A**  
Grade 8

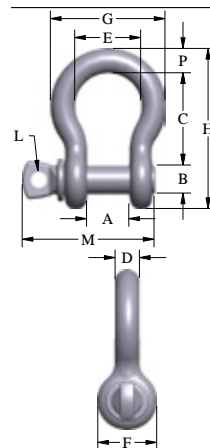

- Forged alloy steel, Quenched & Tempered, with alloy pins.
- Meets performance requirements of Grade 8 shackles.
- Working Load Limit permanently shown on every shackle.
- Hot-dip galvanized.
- Size 3/8 inch is mechanically galvanized.
- Shackles can be furnished proof tested with certificates to designated standards, such as ABS, DNV, Lloyds, or other certification. Charges for proof testing and certification available when requested at the time of order.
- Approved for use at -40° C (-40° F) to 204° C (400° F).
- Meets or exceeds all requirements of ASME B30.26 including identification, ductility, design factor, proof load and temperature requirements. Importantly, these shackles meet other critical performance requirements including impact properties and material traceability, not addressed by ASME B30.26.
- G-209A Screw pin anchor shackles meet the performance requirements of Federal Specification RR-C-271H, Type IVA, Grade B, Class 2, except for those provisions required of the contractor.



### G-209A Alloy Screw Anchor Pin Shackles

Load Rated

QUICK-CHECK®

QT  
QUENCHED & TEMPERED

CE

APPLICATION AND WARNING INFORMATION  
SECTION 17

Nominal Size (in)	Working Load Limit (t)	Stock No.	Weight Each (kg)	Dimensions (mm)														Replacemen Screw Pin Stock No.
				A	Tol. A ±	B	C	Tol. C ±	D	E	F	G	H	L	M	P		
3/8	2	1017450	.14	17	1.5	11	37	3.3	10	26	23	46	64	6	52	10	3.3	
7/16	2.67	1017472	.17	19	1.5	13	43	3.3	11	30	27	52	74	8	60	11	3.3	
1/2	3.33	1017494	.29	21	1.5	16	48	3.3	13	33	30	59	83	10	68	13	3.3	
5/8	5	1017516	.63	27	1.5	19	60	3.3	16	43	38	74	106	11	85	18	3.3	
3/4	7	1017538	1.02	32	1.5	22	71	6.4	19	51	46	89	126	13	101	21	6.4	
7/8	9.5	1017560	1.53	37	1.5	25	84	6.4	22	58	53	103	148	13	114	25	6.4	
1	12.5	1017582	2.41	43	1.5	30	96	6.4	25	68	60	119	167	14	130	27	6.4	
1-1/8	15	1017604	3.31	46	1.5	32	108	6.4	30	74	68	131	190	16	152	32	6.4	
1-1/4	18	1017626	4.31	52	1.5	36	119	6.4	33	83	76	146	210	18	165	35	6.4	
1-3/8	21	1017648	6.01	57	3.3	40	133	6.4	36	92	84	162	233	19	176	38	6.4	

4.5:1 Design Factor. Maximum Proof Load is 2 times the Working Load Limit (metric tons) and 2.2 times the Working Load Limit (short tons). For Working Load Limit reduction due to side loading applications, see Warnings & Applications.

**G-2169**



- Quenched & Tempered for maximum strength.
- Forged alloy steel.
- Available in galvanized finish.
- Can be individually proof tested and magnetic particle inspected upon request. Crosby certification available at time of order.
- Meets or exceeds all requirements of ASME B30.26 including identification, ductility, design factor, proof load and temperature requirements. Importantly, these shackles meet other critical performance requirements including fatigue life, impact properties and material traceability, not addressed by ASME B30.26.
- Look for the Red Pin®... the mark of genuine Crosby quality.

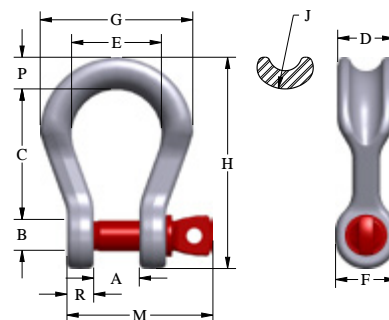

### G-2169 Alloy Screw Pin Wide Body Shackles

Load Rated

QT  
QUENCHED & TEMPERED

APPLICATION AND WARNING INFORMATION  
SECTION 17

Working Load Limit (t)	Stock No.	Weight Each (kg)	Dimensions (mm)														Replacement Screw Pin Stock No.
			A	B +/- .25	C	D +/- .02	E	F	G	H	J	K	L	M	P	R	
7	1021655	1.6	32	22	90	41	64	46	104	149	32	32	13	101	24	18	-
12 1/2	1021673	4.0	43	29	118	54	83	61	140	194	35	41	14	130	32	23	-
18	1021691	5.9	52	35	148	64	102	68	172	238	38	51	18	159	36	30	1083873

5:1 Design Factor. Proof Load is 2 times the Working Load Limit.