

Self Indicating Dynamometer

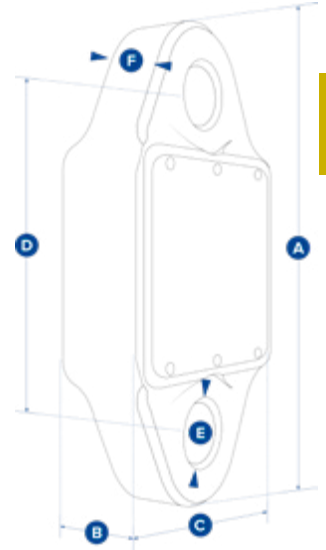

- Large 5mm LCD display
- 0.2% high accuracy
- Overload counter
- 90db Audible set point alarm
- RS-485 serial output
- IP65 / NEMA 4X
- Design validated by F.E.A.
- 2-year warranty
- Design Factor: 6:1
- Battery Type: 9v PP3
- Battery Life: 80 hrs continuous
- Operating Temp: -10 to +50° C
- Accuracy: +/- 0.2% of full scale
- Display Type: 6 digit 25 mm LCD
- Protection: IP65 / NEMA 4X

LOAD MONITORING



Straightpoint Self Indicating Dynamometer (SID)

Stock No.	Model	Capacity (t)	Resolution (t)	Weight (kg)	Dimensions (mm)						Crosby Shackle	
					A	B	C	D	ØE	F		
2789709	SID6T5	6.5	0.001	1.5	224	44	113	156	27.5	33	G2130	1019533

Designed to replace outdated mechanical products still in the field, the Self Indicating Dynamometer (SID) is the latest Crosby Straightpoint product with a self-indicating display that provides accurate load measurements to prevent incidents and injuries.

The SID is a self-indicating version of the popular BlueLink and provides load monitoring solutions where close-up measurements are required, such as when operating lever and chain hoists at height or lifting vehicle motors.

The SID's advanced microprocessor-based electronics deliver high-speed read rates, extreme resistance to industrial-level noise, and unprecedented stability. It features full-function push button controls for:

- Tare and preset tare
- Selectable measurement units (lbs, kg, kN and tonnes)
- 100Hz high-speed peak hold
- Audible set-point alarm
- Overload counter

Designed for use with industry-standard Crosby G-2130 shackles, the SID's compact design minimizes headroom loss (6.14 in from eye to eye).

Constructed with high-grade aircraft-quality aluminum and with a 6:1 Design Factor, its lightweight design does not sacrifice on strength. In fact, Crosby SP link style dynamometers are, on average, 30% lighter than those of other suppliers.