

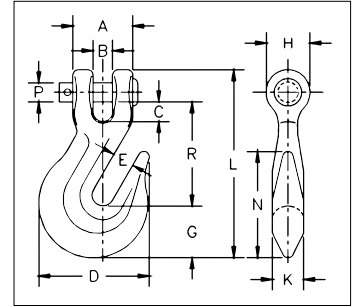

A-330

Clevis Grab Hook

- Forged steel - Quenched & Tempered.
- Design factor is 4:1.
- Features quick and easy assembly.
- Designed for Grade 8 chain.



A-330 Clevis Grab Hooks

Chain Size (mm)	Stock No.	Working Load Limit (t)	Weight Each (kg)	Dimensions (mm)											
				A	B	C	D	E	G	H	K	L	N	P	R
7	1027249*	1.59	.16	25.4	8.15	8.15	46.0	8.65	22.4	18.3	11.9	77.5	44.5	7.85	41.7
8	1027267*	2.04	.29	30.2	9.90	9.90	54.0	11.2	24.6	23.1	15.0	93.0	52.5	9.65	61.5
10	1027285*	3.22	.45	35.1	11.4	11.4	64.5	12.7	29.7	25.4	18.3	109	59.5	11.2	61.0
13	1027329*	8.21	.95	47.8	14.5	14.5	90.5	16.8	38.9	31.8	19.8	145	75.5	16.0	81.0
16	1027347	11.2	1.91	58.0	23.1	23.1	112	19.8	45.2	39.6	27.7	179	109	19.1	104
19	1027365	11.2	2.95	66.5	23.9	23.9	133	23.9	54.0	47.8	33.3	207	129	22.4	118

* These A-330 hooks are forged with an "8" designating Grade 80, and are suitable for use with Grade 8 chain in overhead lifting applications as long as the hook is proof-tested as part of the chain sling assembly or as an individual component per ASME B30.9. We recommend the use of the A-1338 / A-1358 which is proof tested and supplied with a proof test certificate.

Crosby LEBUS L-180



- Hooks are Forged – Quenched & Tempered.
- Individually Proof Tested.
- Spectrum 8® alloy steel from 20mm through 32mm (3/4" - 1-1/4").
- Meets or exceeds requirements of US DOT FMCSA Part 393 Subpart I.

Crosby LEBUS L-180 Winchline Tail Chain

Wire Rope Diameter (mm)*	Stock No.	Working Load Limit (kg)†	Length (mm)	No. of Links	Weight Each (kg)
19 - 22	1091511	15,510	610	8	8.25
25 - 29	1091516	21,640	457	5	9.60
25 - 29	1091525	21,640	610	7	10.6

* Recommended for IPS or XIP (EIP), RRL, FC or IWRC wire rope. † Ultimate Load is 3.5 times the Working Load Limit.